

Tahoe Forest Hospital

First Level

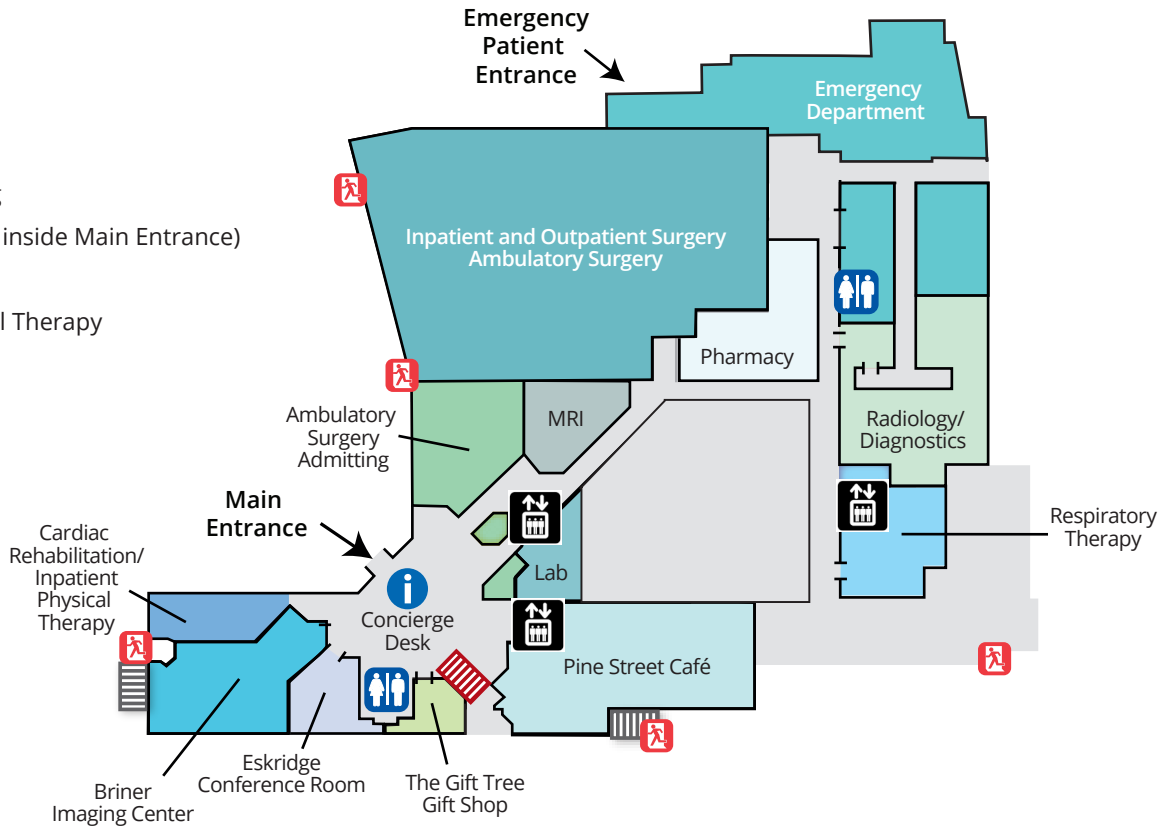

- Ambulatory Surgery Admitting
- Bill Pay (Go to Concierge Desk inside Main Entrance)
- Briner Imaging Center
- Cardiac Rehabilitation/Physical Therapy
- Conference Room
- Emergency Department
- Lab
- Pharmacy
- MRI
- Pine Street Café
- Radiology/Diagnostics
- Respiratory Therapy
- Surgery/Ambulatory Surgery
- The Gift Tree Gift Shop

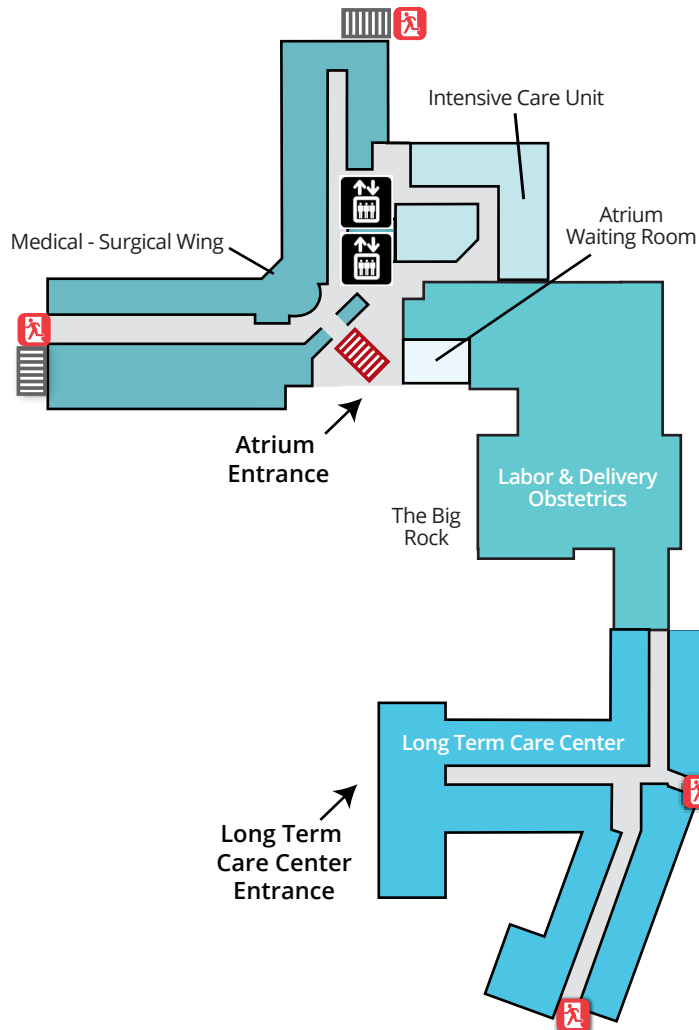

Second Level

- Intensive Care
- Labor & Delivery/Obstetrics
- Long Term Care
- Medical-Surgical Wing



	Information Desk
	Elevator
	Public Stairs
	Emergency Exit
	Restroom